

### Typical floor finishes

Ceramic tiles, marble, terrazzo, concrete, resin, wood and all hard floors.

### Performance

Up to 5 tonne pneumatic tyre wheel load (cars and light delivery vehicles).

### Options

Every cover is available with a choice of aluminium or brass show edge, and matching lifting blocks, or Colouredge high impact pvc edges with aluminium lifting blocks (see website). Double seal. 3 hour fire rating to BS 476: Part 20: 1987 available; ask for indicative test report.



Hard floor finishes



Single covers



Cars and light delivery vehicles

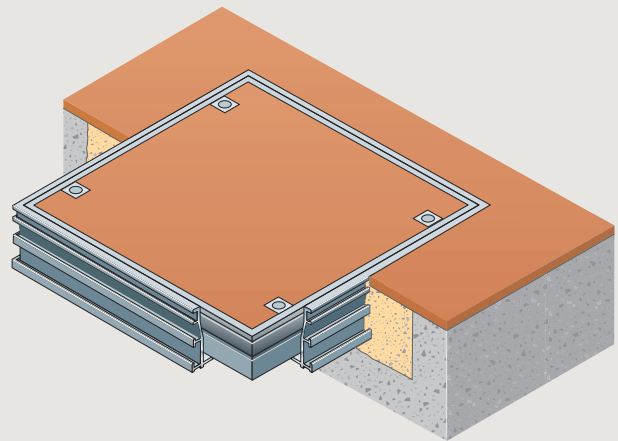

### Cross section showing concrete and timber sub-floors (scale 1:2)

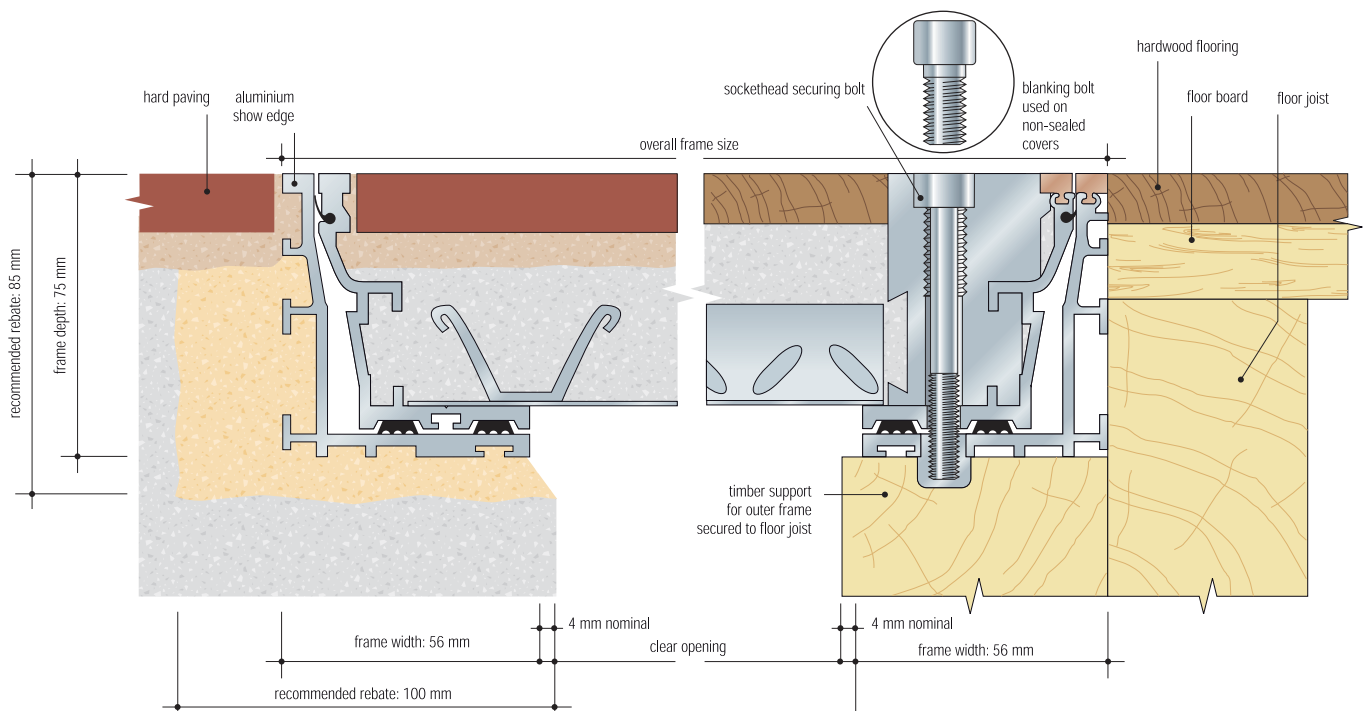

### Typical specification clause for 7500 series

Recessed floor access/ duct/ multipart\* covers and frames shall be Howe Green Ltd 7500 series, with 3 hour fire rating to BS 476: Part 20: 1987\*, aluminium / brass / Colouredge\* top edge dirt seal and mechanically jointed corners, galvanised base plate and reinforcement, double sealed with socket head securing bolts/ unsealed with blanking bolts\*. Sizes shall be as shown on contract drawings nos ....† Covers to be supplied complete with ....† sets of combined lifting/ securing keys. All to be manufactured and supplied by Howe Green Ltd, Marsh Lane, Ware, Hertfordshire, SG12 9QQ, Great Britain, and installed in accordance with the manufacturer's installation details and sitework guide.

\* Delete as appropriate. † Insert appropriate numbers & quantities

### Size

Overall frame size = clear opening + 120 mm e.g. 600 x 900 mm clear opening = 720 x 1020 mm overall frame.

Performance Note Trucks with small wheels and solid tyres, such as pallet rollers, may limit sizes to less than the stated maximum span. Alternatively, greater spans may be used, but at reduced loadings.

### Weight

A 7500 series cover when filled with concrete weighs approx. 155 kg/m².

See installation guide on page 28.

### Maximum / minimum sizes

