

### Typical floor finishes

Ceramic tiles, marble, terrazzo, concrete, resin, wood and all hard floors.

### Performance

Pedestrian traffic (including wheeled trolleys, sack trucks etc.) only.

### Options

Every cover is available with a choice of aluminium or brass show edge, and matching lifting blocks, or Colouredge high impact pvc edges with aluminium lifting blocks (see website). Double seal. 1 hour fire rating to BS 476: Part 20: 1987 available; ask for indicative test report.

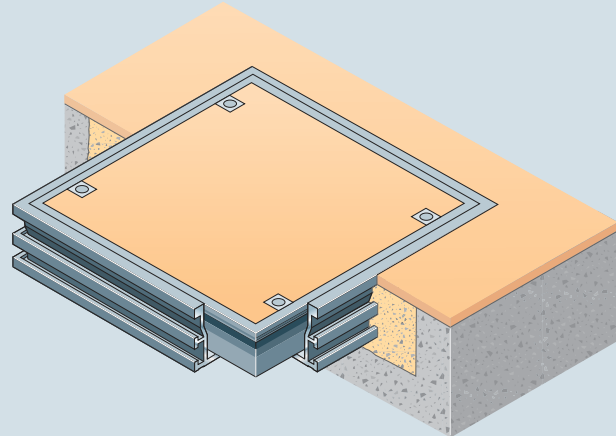

Hard floor finishes



Single covers



Pedestrian traffic

### Cross section showing concrete and timber sub-floors (scale 1:2)

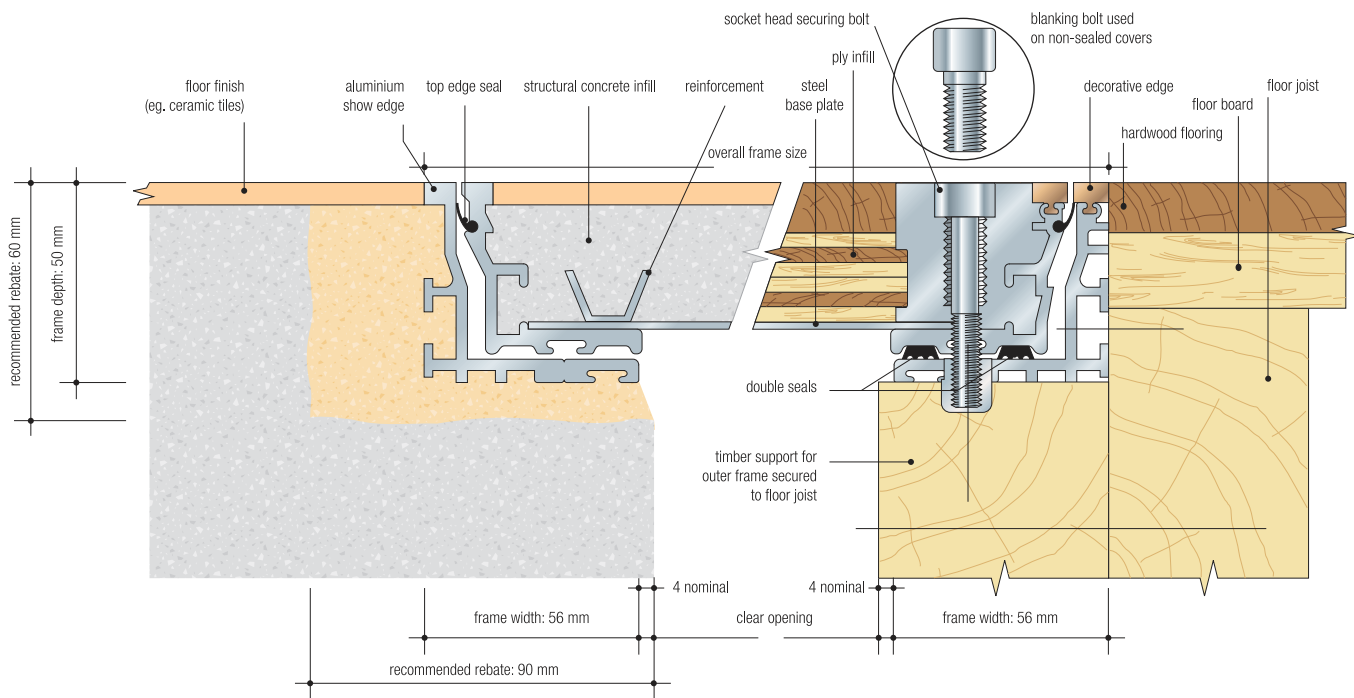

### Typical specification clause for 5000 series

Recessed floor access/ duct/ multipart\* covers and frames shall be Howe Green Ltd 5000 series with 1 hour fire rating to BS 476: Part 20: 1987, continuously fastened aluminium/ brass/ Colouredge\*, top edge dirt seal and mechanically jointed corners, galvanised baseplate and reinforcement, double sealed with socket head securing bolts/unsealed with blanking bolts\*. Sizes shall be as shown on contract drawings nos ....† Covers to be supplied complete with ....† sets of combined lifting / securing keys. All to be manufactured and supplied by Howe Green Ltd, Marsh Lane, Ware, Hertfordshire, SG12 9QQ, Great Britain, and installed in accordance with the manufacturer's installation details and sitework guide.

\* Delete as appropriate. † Insert appropriate numbers & quantities

### Size

Overall frame size = clear opening + 120 mm e.g. 600 x 600 mm clear opening = 720 x 720 mm overall frame.

### Weight

A 5000 series cover when filled with concrete weighs approx. 90kg/m<sup>2</sup>.

See installation guide on page 28.

### Maximum / minimum sizes

