

Typical floor finishes

External grade paving slabs including granite and concrete.

Performance

Up to 6.5 tonne pneumatic tyre wheel load.

Options

Double seal. Inset lifting points. 3 hour fire rating to BS 476: Part 20: 1987 available; ask for indicative test report.

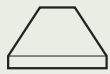
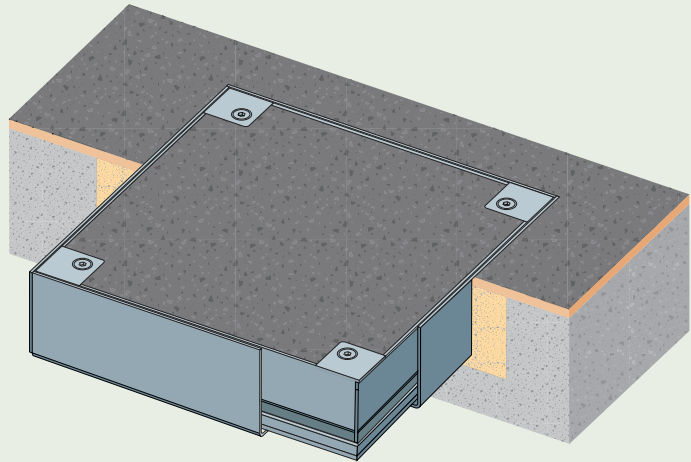
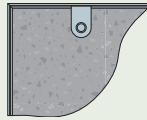

Hard floor finishes



Single covers



Cars and light delivery vehicles

Cross section showing concrete sub-floor

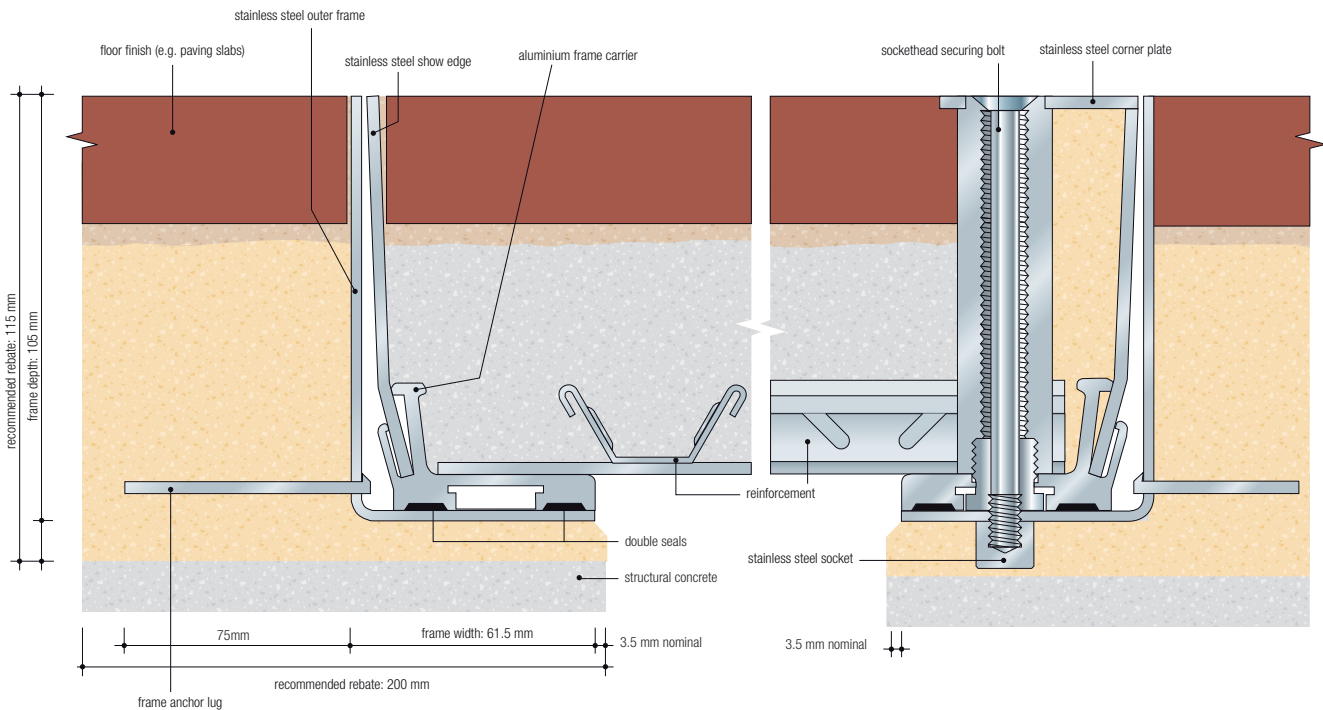

Typical specification clause for 1050 series

Recessed floor access/ duct/ multipart* covers and frames shall be Howe Green Ltd 1050 series, with 2 hour fire rating to BS 476: Part 20: 1987*, stainless steel with galvanised base plate and reinforcement, double sealed with socket head securing bolts/ unsealed with blanking bolts*. Sizes shall be as shown on contract drawings nos ...† Covers to be supplied complete with ...† sets of combined lifting/ securing keys. All to be manufactured and supplied by Howe Green Ltd, Marsh Lane, Ware, Hertfordshire, SG12 9QQ, Great Britain, and installed in accordance with the manufacturer's installation details and sitework guide.

* Delete as appropriate. † Insert appropriate numbers & quantities

Size

Overall frame size = clear opening + 130 mm e.g. 600 x 900 mm clear opening = 730 x 1030 mm overall frame.

Weight

A 1050 series cover when filled with concrete weighs approx. 220 kg/m². See installation guide on page 28.

Maximum / minimum sizes

